

CX2109NL

RF Transformer
1:1, 4.5 – 3000MHz
Impedance = 50 Ohms
Surface Mount, FR4 Substrate

ELECTRICAL SPECIFICATIONS @ 25°C:

NOTES: UNLESS OTHERWISE SPECIFIED:

1. OPERATING TEMPERATURE: -40°C TO +85°C.
2. STORAGE TEMPERATURE: -50°C TO +125°C
3. JEDEC MOISTURE: LEVEL 3.
4. DIMENSIONS ARE IN INCHES WITH THE FOLLOWING TOLERANCES:
.XX= ±.01
.XXX= ±.005
5. REVISION LEVEL MP1...MPX IS FOR PROTOTYPE RELEASED PRODUCTS.
6. ROHS COMPLIANT



PARAMETER	FREQUENCY (Hz)	CALCULATED ATTENUATION
INSERTION LOSS: AT +25°C	4.5 – 1000 M	1.0 dB MAX
	1000 – 2000 M	2.0 dB MAX
	2000 – 3000 M	3.5 dB MAX
PHASE UNBALANCE:	4.5-1000 MHz	20 DEG MAX
AMPLITUDE UNBALANCE:	4.5-1000 MHz	1.0 dB MAX

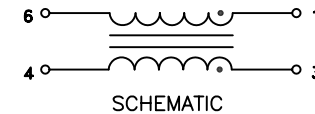

SCHEMATIC

© Copyright, 2014. Pulse Electronics Corp. All rights reserved. Drawing specifications subject to change without notice. (03/11/14)

PULSE CONFIDENTIAL
&
PROPRIETARY

PRODUCT SPECIFICATION:
XFMR,RF,1:1,4.5-3000MHZ,RAC,SMT

PS DRAWING
PS-0078.001

DWG. NO./ PART NO.
CX2109NL

SHEET:
1

REV.
MP1

MECHANICAL SPECIFICATIONS:

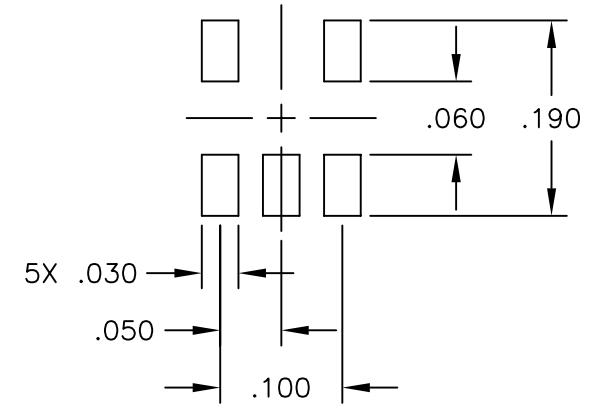
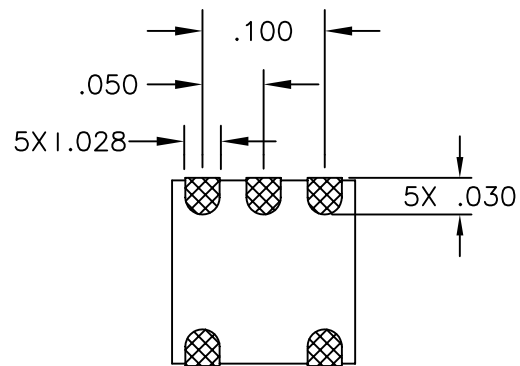
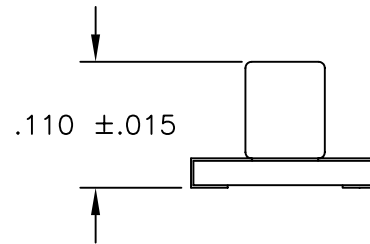
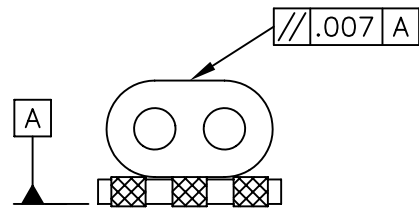
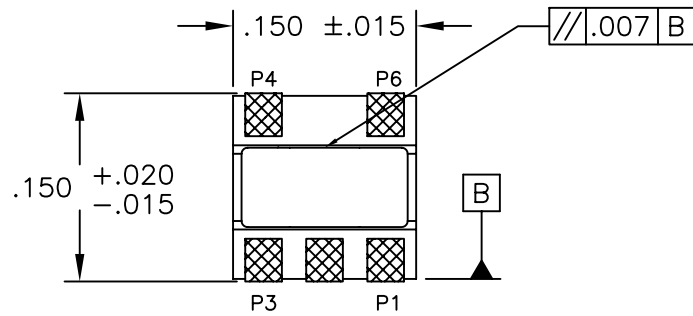

SUGGESTED LAND PATTERN

© Copyright, 2014. Pulse Electronics Corp. All rights reserved. Drawing specifications subject to change without notice. (03/11/14)

PULSE CONFIDENTIAL
&
PROPRIETARY

PRODUCT SPECIFICATION:
XFMR, RF, 1:1, 4.5-3000MHz, RAC, SMT

PS DRAWING
PS-0078.001

DWG. NO./ PART NO.
CX2109NL

SHEET: REV.
2 MP1