

NOTES:

- MATERIALS AND FINISHES:  
 BODY, HOUSING, COVER & SHELL - BRASS, NICKEL PLATING  
 CONTACT - BRASS, GOLD PLATING  
 INSULATOR - PTFE, NATURAL  
 FERRULE - COPPER, NICKEL PLATING
- ELECTRICAL:  
 A. IMPEDANCE: 75 OHM
- MECHANICAL:  
 A. DURABILITY: 500 CYCLES MIN.  
 B. TEMPERATURE RANGE: -65° C TO +165° C
- PACKAGING:  
 A. QUANTITY: SINGLE PACK  
 B. MARKING: BAG TO BE MARKED  
 "AMPHENOL RF, 222153, AND DATE CODE"
- CABLE ASSEMBLY INSTRUCTIONS:  
 A. TRIM CABLE AS SHOWN.  
 B. SOLDER CONTACT TO CABLE CENTER CONDUCTOR.  
 C. CRIMP FERRULE WITH 6.48 [0.255"] HEX.

6 SHOWS CABLE ENTRY DIMENSIONS.

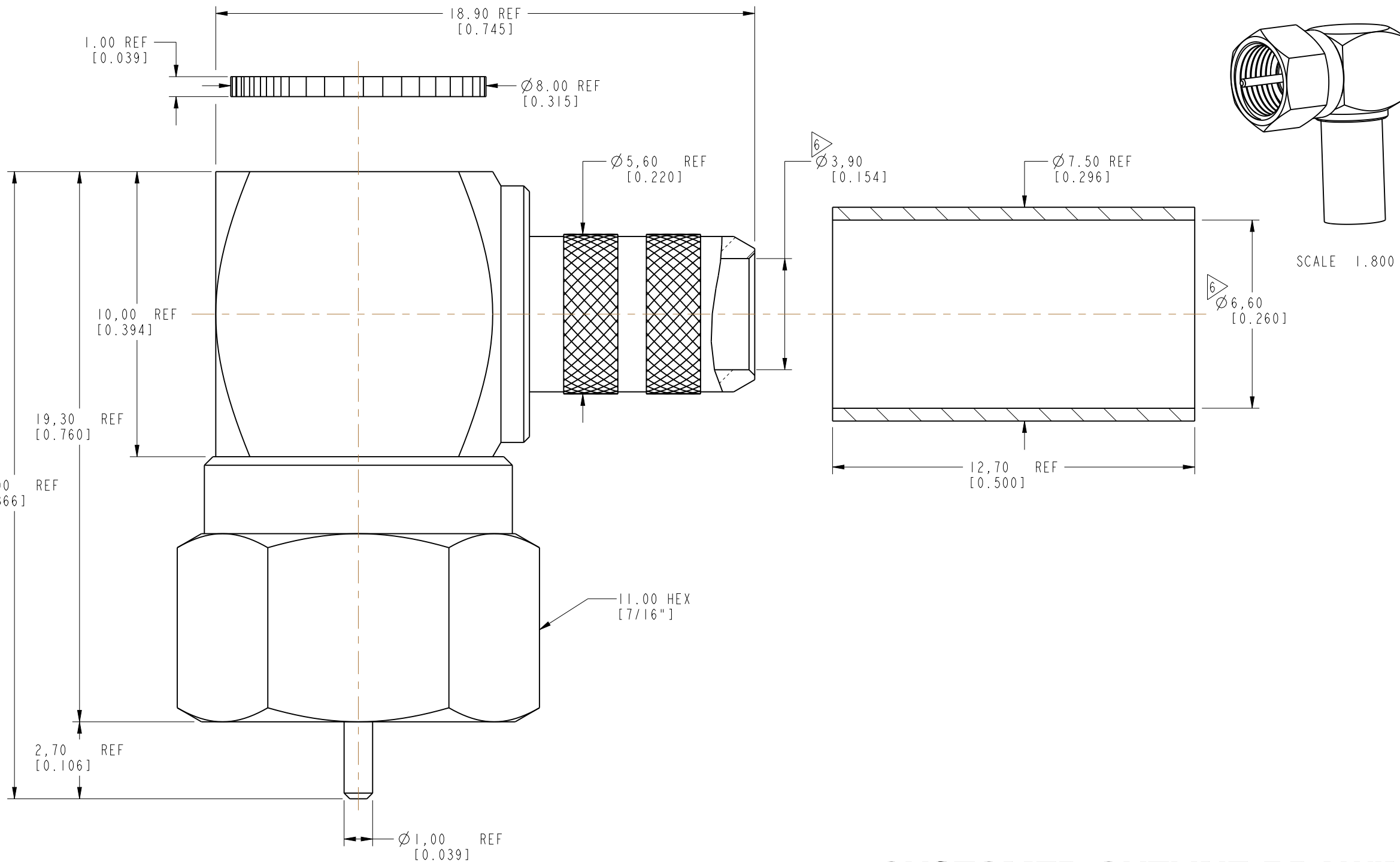
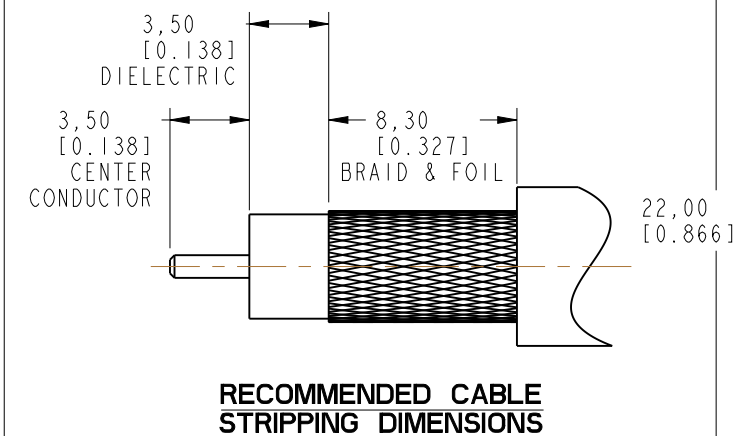

THIRD ANGLE PROJ.

REVISIONS

REV	DESCRIPTION	DATE	ECO	APPR
--	RELEASE TO MFG	--	--	
C	CENTER CONTACT LENGTH UPDATED	22-Feb-09	--	
D	REDRAWN IN PRO-E & Ø1.00 WAS Ø0.80	7/17/15	50612	AAP

**CUSTOMER OUTLINE DRAWING**

ALL OTHER SHEETS ARE FOR INTERNAL USE ONLY

UNLESS OTHERWISE SPECIFIED, DIMENSIONS ARE IN METRIC AND TOLERANCES ARE: <0.5mm ±0.05mm    0.5 - 6mm ±0.1mm    6 - 30mm ±0.2mm    30 - 120mm ±0.3mm    ANGLES ±1°	MATERIAL	DRAWN	DATE	TITLE F RA CRIMP PLUG FOR RG-59/U CABLE		Amphenol RF www.amphenolrf.com		
	SEE NOTES	A ARUN PRABU	16-Jun-15					
	REFERENCE	ENGINEER	DATE	SCALE: 6.3:1.0   SHEET 2 OF 2		DRAWING NO.222153 ITEM NO.222153		
	EAR #6377	K.CAPOZZI	16-Jun-15					
CONFIGURATION LEVEL: In Work	APPROVED	DATE	DWG SIZE B		REV D		PART NO.222153	
FINISH		7/17/15						